

Edge Restraint **TECHNICAL DATA SHEET**

PRODUCT DESCRIPTION:

Low Profile is a contractor grade edge restraint designed to be used with paving units less than 2" in height. Its injection molded design made of 100% recycled HDPE (high density polyethylene) has built-in features that provide strength and stability. Low Profile is a **"One Piece Does It All"** system that can be used on straightaways, curves and even a complete radius without waste.

FEATURES	BENEFITS
"One Piece Does It All" Design with Snip N Flex Feature	<ul style="list-style-type: none"> • Only One Piece to Inventory • Use On Straightaways, Curves & Complete Radius • Less Waste
Rugged Injection Molded HDPE Design	<ul style="list-style-type: none"> • Resists Warping • Ensures the Strongest Edge
Strong Interlocking Integrated Joint	<ul style="list-style-type: none"> • Makes a Secure Connection without Extra Parts • Continuous Edge Keeps Bedding Material in Place • Provides Extra Support
Reinforced Nail Bosses	<ul style="list-style-type: none"> • Securely Holds Edging In Place
Open Base Design	<ul style="list-style-type: none"> • Allows for Grass Growth Along Edge of Paving Unit Creating a Strong Yet Invisible Edge
Simple To Install	<ul style="list-style-type: none"> • Can Be Installed Before or After the Paving Units Have Been Laid • Installs with Common 8" - 12" Landscape Spike

APPLICATIONS: For paving units less than 2" in height.

Low Profile is designed for residential & commercial paver, stone and porcelain installations on a conventional base and is the ideal edge restraint for walkways, patios, courtyards and driveways with residential levels of traffic. Low Profile is designed to work best when following ICPI recommended best practices for installing segmental pavement systems. **CAUTION:** Do not use alongside freshly place asphalt due to the high temperatures of the asphalt (HDPE melting point is 250°F (121°C)).

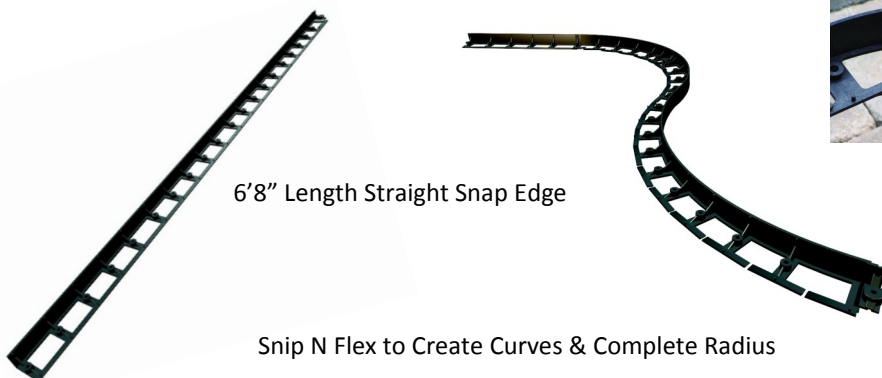

Snip N Flex Feature



Low Profile Interlocking Joint that Secures with Spike

INSTALLATION REQUIREMENTS FOR OPTIMAL PERFORMANCE

- Follow ICPI recommendations for base installation. See ICPI's **Tech Spec 2** and **Tech Spec 10** and diagram below. Base material should extend a **minimum of 6"** past the paving units or equal to the depth of your base if it is greater than 6".
- Install Low Profile before compaction of surface.
- All excess bedding material that extends outside the perimeter of the project should be removed down to the base layer before installing Low Profile.
- Low Profile is to be installed on base layer not on the bedding layer.
- Installed Low Profile should not extend to the top of the paving unit. Cover Low Profile with back-fill.

INSTALLATION CROSS-SECTION BEST PRACTICES:

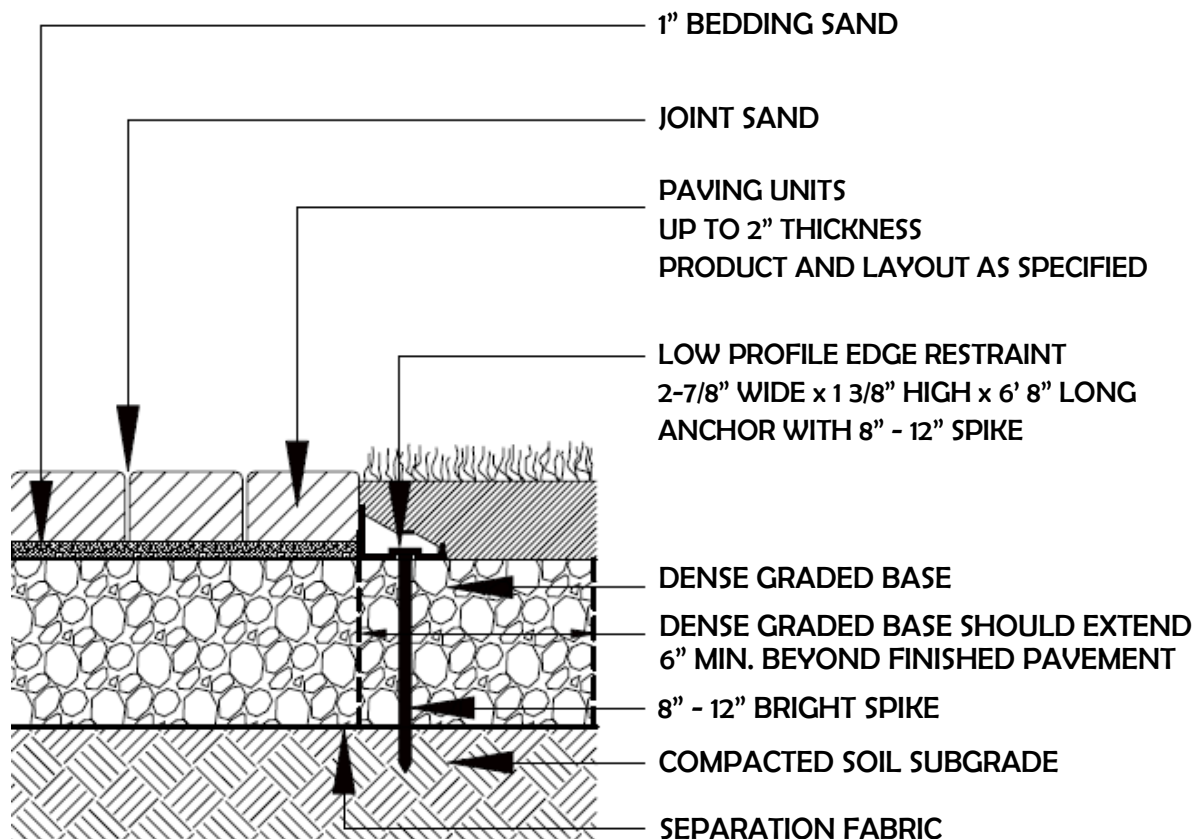

NOTES:

- THE INSTALLATION DETAIL SHOWN ABOVE HAS BEEN PROVIDED FOR REFERENCE ONLY
- THE MATERIAL, DEPTH AND COMPACTION REQUIREMENTS OF THE SUBGRADE, DENSE GRADED BASE, AND BEDDING SAND MATERIALS SHOULD ALWAYS BE DETERMINED ON A PROJECT-BY-PROJECT BASIS

INSTALLATION INSTRUCTIONS:

- Consult your paving stone supplier or soils engineer to determine the proper base depth for your installation.
- Excavate, install and compact dense graded base at least 6" (or equal to the depth of your base if it is greater than 6") past the perimeter of the proposed paved area.
- Remove any excess bedding sand adjacent to the paving units where edging will be installed. (Do not install edging on top of the bedding sand.)
- Place edging on top of the compacted dense graded base and directly up against the pavers.
- Connect all pieces together using the build-in integrated connectors.
- Snip the outer edge of Low Profile to allow for inside and outside radius if required. Snip on an angle and flex.
- On pieces you have to shorten, always leave the connector side intact so it will connect to the neighboring piece. Place spikes in every hole for extra support.
- Spike Low Profile into compacted aggregate base.



Spike Placement Guidelines:

- For Patios and Walkways: place a spike every 18" - 24" except at sharp curves or corners where more concentration is needed.
- Corners: Place one spike on each side.
- Curves: Place one spike in each hole until curve is complete.
- For Residential Vehicular Applications: Place a spike every foot, except at sharp curves or corners, then complete same as above.
- For Commercial Applications (non-vehicular): Place a spike every 8", except at sharp curves or corners, then complete same as above.
- Backfill the entire perimeter with topsoil and then sod. The full depth backfill allows the roots to help anchor the edging in place. Alternative backfill such as mulch or decorative stone may be used. Backfill is important for appearance and prevents UV damage to the HDPE plastic over time.

SPECIFICATIONS/PACKAGING:

- 6' 8" length piece
- 24 pieces/bundle
- 160 lineal ft./bundle
- 288 pieces per half pallet (12 bundles)
- 672 pieces per full pallet (28 bundles)



STORAGE:

- Best if stored in original bundles on pallet

DISPOSAL:

Dispose of in accordance with all applicable laws and regulations.

ENVIRONMENTAL INFORMATION:

All edge restraints produced by SEK (Snap Edge, Snap Edge Low Profile and Barrier) are made from 100% recycled high density polyethylene (HDPE). The recycled HDPE comes from both post-consumer and post industrial material. HDPE is an inert material, versus PVC which is not, eliminating the concern of environmental contamination into the soil or atmosphere.

WARRANTY:

SEK-Surebond warrants its products to substantially conform to its published specifications at the time of purchase. The foregoing is the sole limited warranty applicable to the products. **SEK-SUREBOND HEREBY DISCLAIMS ALL OTHER WARRANTIES OF ANY KIND OR NATURE, WHETHER EXPRESS, IMPLIED, OR STATUTORY, INCLUDING WITHOUT LIMITATION THE IMPLIED WARRANTIES OF MERCHANTABILITY, FITNESS FOR A PARTICULAR PURPOSE, OR ANY OTHER WARRANTY OTHER THAN THE WARRANTY SET FORTH ABOVE.** The user is solely responsible for determining suitability of the products for their particular use. While the actual application of this product is out of the control of SEK-Surebond, it is recommended that the application guidelines be followed completely and accurately. SEK-Surebond's liability for any damage shall not exceed the purchase price of the product used, and it shall have no liability for consequential, incidental or punitive damages.